

Electrical

Impedance	50 ohm
Frequency Range	26.3-40.0 GHz
VSWR	1.2 max
Input Avg Power	15 Watts @ 25°C
Operating Temperature	-40°C~+70°C

Mechanical

Waveguide Size	WR28(R320)
Flange Type	IEC: UBR320
Waveguide Material	Copper
Waveguide Finish	Grey painted

Dimensions(mm)

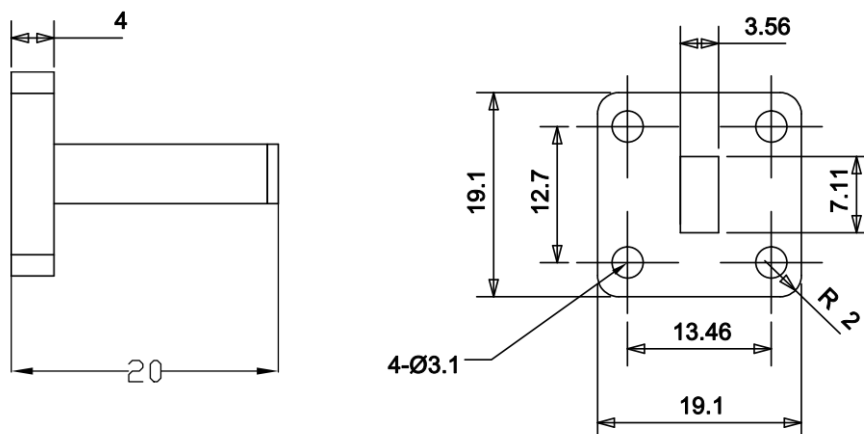



Typical Test Data

