



Electrical

Impedance	50 ohm
Frequency Range	3.22-4.90 GHz
VSWR	1.03 max
Input Avg Power	10 Watts @ 25°C
Operating Temperature	-40°C~+70°C

Mechanical

Waveguide Size	WR229(R40)
Flange Type	IEC: UDR40
Waveguide Material	Aluminum
Waveguide Finish	Grey painted

Dimensions(mm)

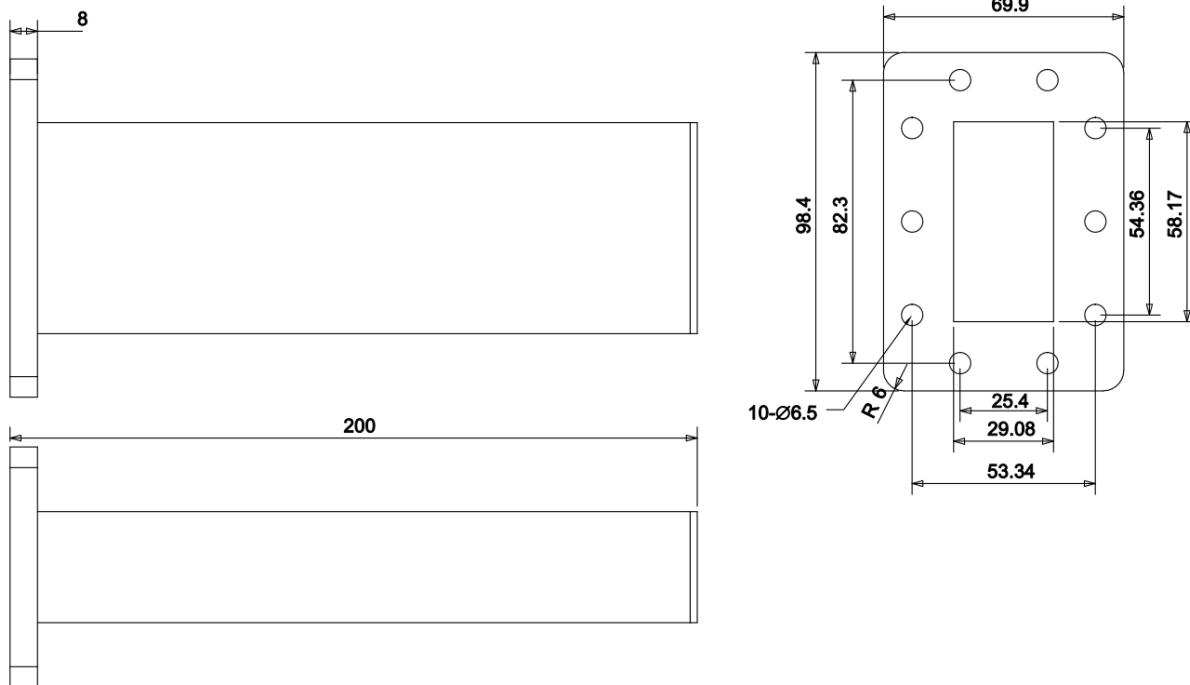



Typical Test Data

