

### Drawing(mm)

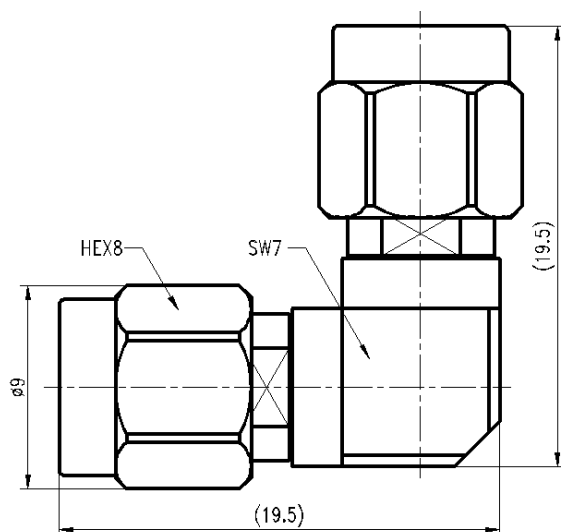

### Electrical & Environmental

Impedance	50 ohm
Frequency Range	DC-27 GHz
VSWR	1.25 max
Operating Temp	-55°C to +165°C
Interface	3.5mm per IEC 60169

### Material

Connector Body	Passivated stainless steel
Center Contact	Gold plated beryllium copper
Insulator	PEI

### Typical Test Data

