

### Drawing(mm)

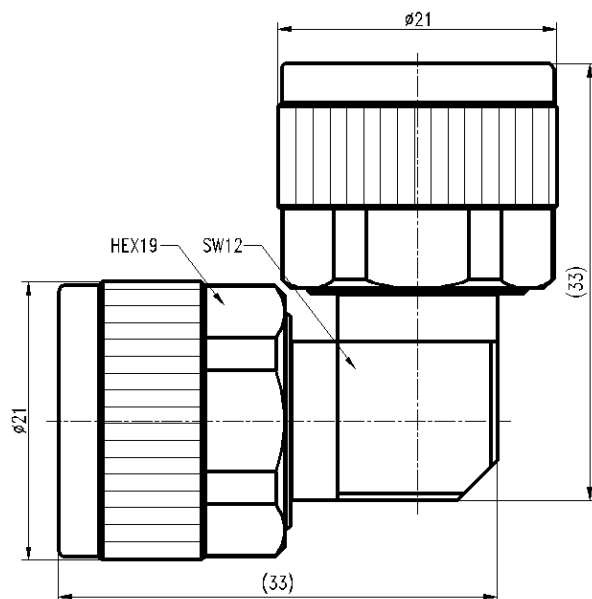

### Electrical & Environmental

Impedance	50 ohm
Frequency Range	18 GHz
VSWR	1.2 max
Operating Temp	-55°C to +165°C
Interface	MIL-STD-348B

### Material

Connector Body	Passivated stainless steel
Center Contact	Gold plated brass
Insulator	PEI

### Typical Test Data

