

PRODUCT DATA SHEET

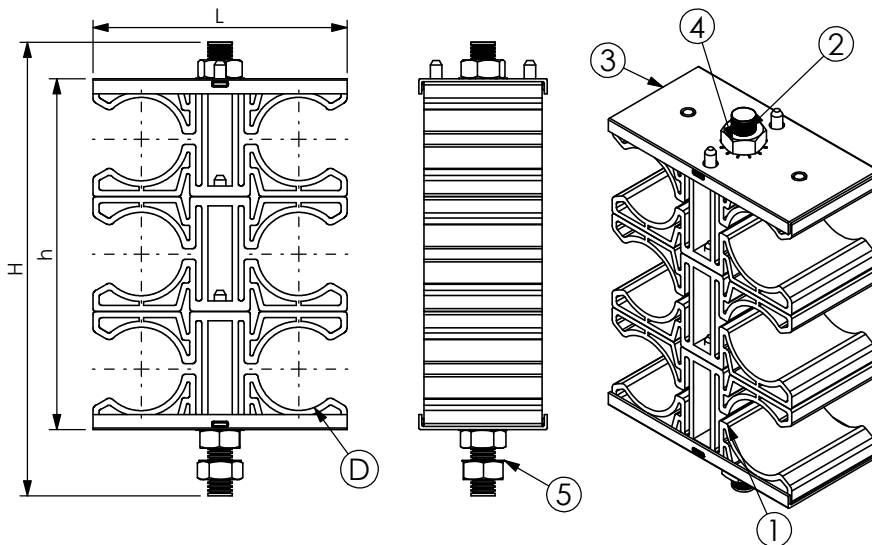

A) SPECIFICATIONS

- 1 Calibrated twin black saddles made in H.D.P.E
- 2 Stainless steel threaded bar BFI M8
- 3 Stainless steel pressure plate PSAL
- 4 Stainless steel hexagonal nut DA1 8
- 5 Stainless steel flat Washer REI 8

B) RESISTANCE TESTS

UV Test BS-ISO 105-B06
Vibration test conforming to UNI 60068-2-6
Operating temperature: -30°C +120°C



C) PACKAGING INFORMATION

Packing in boxes.
Label indicating:
product code, article, quantity,
production batch,
FIMO logo and figure.
(Customer code on request).

D) MOUNTING INSTRUCTIONS

On request

CODE	ARTICLE	ø D	L	h	H	BOX	WEIGHT
61 1562 6012	LCO/ 6x1/2"	15 - 17	62	125	84	20	215
61 1562 6078	LCO/ 6x7/8"	27 - 29	84	150	117	20	245
61 1562 6114	LCO/ 6x1.1/4"	38 - 40	102	200	153	20	335
61 1562 6158	LCO/ 6x1.5/8"	50 - 52	119	250	186	20	385

RI	DATE	DR	DATE	AP	<div>Description:</div> <div>LCO - Quick-fit Fasteners for Flat with Holes</div> <div><div>• Side Insertion of Cables</div><div>• Elastic Prefixing</div><div>• Manual Final Locking</div></div>
02					
01					
00	03/11/2015	G.S.	03/11/2015	A.V.	
1 ST EMISSION					
<div><div></div><div>Setting Installation Standards</div></div>				<div><div></div><div>RoHS</div></div>	<div>Use:</div> <div>Fastening of 6 cables on flat iron with holes</div>