

CONTROL DRAWING

26_SMP-50-2-2/111_NE

A

RoHS 6 COMPLIANT

NOTES:

1. DESCRIPTION:

CONNECTOR, SMP FEMALE FOR
.086 [2.18] DIA. SEMI-RIGID CABLE.

1. MATERIALS AND FINISHES:

CENTER CONDUCTOR, SMP BODY AND EMI RING
BERYLLIUM COPPER ALLOY PER ASTM B-196,
UNS No. C17300, TEMPER TD04(H),
GOLD PLATED 4 μIN. [0.1 μM] MIN. THK.
PER ASTM B-488, CODE C, TYPE I, CLASS 0.25,
OVER
NICKEL PLATE, 80 μIN. [2.0 μM] MIN. THK.
PER ASTM B-733, TYPE V, CLASS 3,
OVER
COPPER FLASH, 4 μIN. [0.1 μM] MIN. THK.
PER SAE-AMS-2418.

CAP

BRASS, FREE CUTTING, PER ASTM B-16 UNS No. C36000
GOLD PLATED 4 μIN. [0.1 μM] MIN. THK.
PER ASTM B-488, CODE C, TYPE I, CLASS 0.25,
OVER
NICKEL PLATE, 80 μIN. [2.0 μM] MIN. THK.
PER ASTM B-733, TYPE V, CLASS 3,
OVER
COPPER FLASH, 4 μIN. [0.1 μM] MIN. THK.
PER SAE-AMS-2418.

DIELECTRIC,

POLYTETRAFLUOROETHYLENE (PTFE) PER
ASTM D-1710, OR ASTM D-4894,
TYPE I, GRADE 1.

2. ELECTRICAL CHARACTERISTICS:

IMPEDANCE
50.0 Ohms NOMINAL.
FREQUENCY
40.0 GHz MAX.

3. SMP INTERFACE MEETS MIL-STD-348.

4. OPERATING TEMPERATURE RANGE:

-55° C TO +125° C

5. CABLE ATTACHMENT METHOD:

CENTER CONDUCTOR,
SOLDERED
OUTER CONDUCTOR,
SOLDERED.

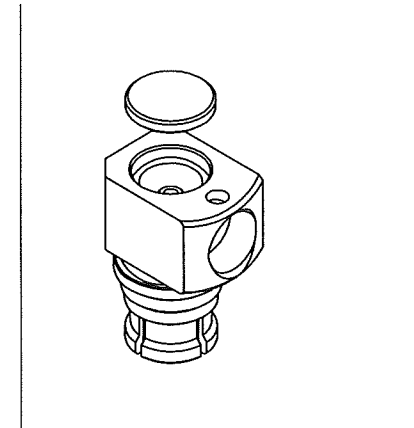
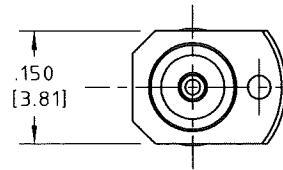

.090 [2.29] DIA.
ACCEPTS
.086 [2.18] DIA.
SEMI-RIGID
CABLE

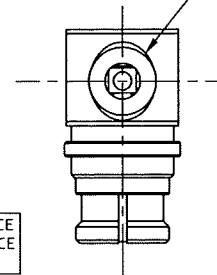
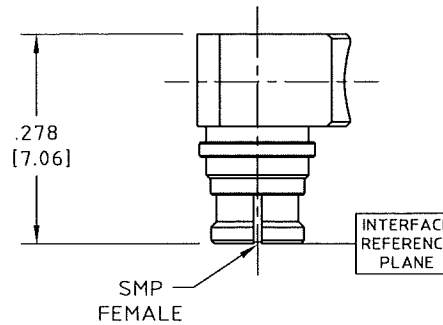

METRIC TOLERANCE			
DIMENSION		TOLERANCE	
INCHES	MM	INCHES	MM
.X	[X.]	±.015	[±0.5]
.XX	[X.X]	±.010	[±0.3]
.XXX	[X.XX]	±.002	[±0.05]
.XXXX	[X.XXX]	±.0005	[±0.013]

SAP ID: 80377839

NAME	DATE
PREP. SO <i>ENG 07</i>	02/16/16
ELEC.	
MECH. <i>[Signature]</i>	02/16/16
Q.C.	



THIS DRAWING CONTAINS PATENTABLE AND PROPRIETARY INFORMATION. THE DESIGN CANNOT BE USED WITHOUT WRITTEN PERMISSION OF HUBER + SUHNER ASTROLAB.

UNLESS OTHERWISE SPECIFIED
CONCENTRICITY .004 T.I.R.
CORNERS AND FILLETS .005
MAX. RADIUS OR CHAMFER.
SURFACE FINISH 63 RMS
MICROINCHES OR BETTER.

FRACTIONS	±	
X	±	.030
XX	±	.015
XXX	±	.005
ANGLES	±	1°

DO NOT SCALE DRAWING

TITLE
CONNECTOR, SMP FEMALE TO .086 [2.18] SEMI-RIGID

REV.	DESCRIPTION	DATE	BY	APPROVED	THDS. TO BE IN ACCORD WITH U.S. DEPT. OF COMM. SCREW THD. STDS. FOR FEDERAL SERVICES 1950 SUPL. TO HANDBOOK H 28.	SCALE	CODE IDENT.	DWG NO.	REV
A	ECN No. 17879	02/16/16	<i>[Signature]</i>	<i>[Signature]</i>	4:1	16301	26_SMP-50-2-2/111_NE	A	