

# Assembly instruction Series H4

0000179536

Old instruction No. 03012



|                  |   |                          |          |
|------------------|---|--------------------------|----------|
| Connector type:  | 11/21_H4-50-3-1 ; 11/21_H4-50-4-1 ; 11/21_H4-50-5-1 | Inner conductor contact: | Soldered |
| Suitable cables: | RG 58 C/U ; RG 59 B/U ; G 05232                     | Outer conductor contact: | Screwed  |

## Parts list connector:

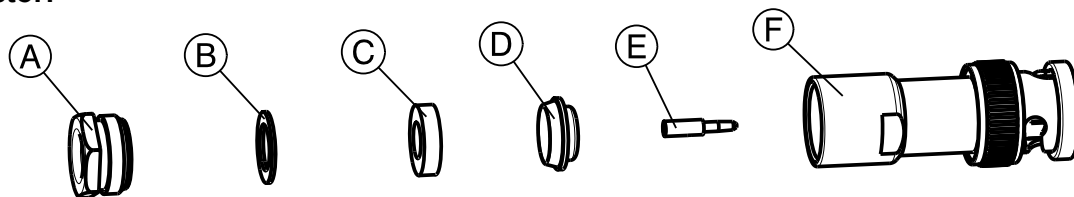

## Assembly steps:

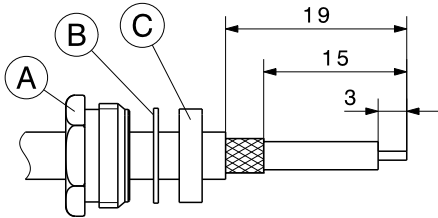
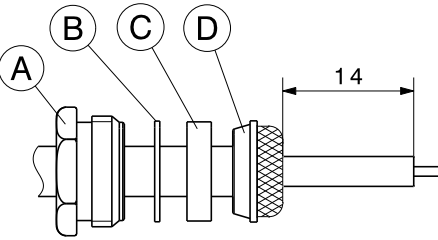
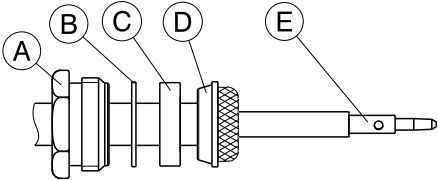
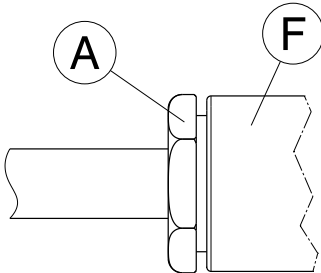
| Picture   | Process   | Feature / Check  | Tools required                       |             |           |                 |   |           |                 |     |           |                 |    |   |  |
|---|---|--|--------------------------------------|-------------|-----------|-----------------|---|-----------|-----------------|-----|-----------|-----------------|----|---|--|
|    | <p>Slide nut A, washer B and gasket C onto cable.</p> <p>Prepare cable according to diagram.</p>  | <p>Do not damage braid, dielectric and inner conductor of cable.</p> | <p>Stanley blade</p> <p>Scissors</p> |             |           |                 |   |           |                 |     |           |                 |    |   |  |
|   | <p>Position braid clamp D that is shoulder fits against cable sheath.</p> <p>Fold back braid over clamp D.</p>  | <p>Check dimension of 14 mm.</p>                                     |                                      |             |           |                 |   |           |                 |     |           |                 |    |   |  |
|  | <p>Push contact E over inner conductor of cable and solder.</p>   | <p>Contact E flush to dielectric.</p>                                | <p>Solder iron</p> <p>Solder</p>     |             |           |                 |   |           |                 |     |           |                 |    |   |  |
|  | <p>Push prepared cable into connector body F and tighten nut A.</p> <table border="1"><thead><tr><th>Cable Dielectric size</th><th>Description</th><th>Torque (Nm)</th></tr></thead><tbody><tr><td>... 3 ...</td><td>11/21_H4-50-3-1</td><td>4</td></tr><tr><td>... 4 ...</td><td>11/21_H4-50-4-1</td><td>5.5</td></tr><tr><td>... 5 ...</td><td>11/21_H4-50-5-1</td><td>10</td></tr></tbody></table> | Cable Dielectric size  | Description                          | Torque (Nm) | ... 3 ... | 11/21_H4-50-3-1 | 4 | ... 4 ... | 11/21_H4-50-4-1 | 5.5 | ... 5 ... | 11/21_H4-50-5-1 | 10 | <p>Do not rotate cable in connector body.</p> | <p>Spanner:<br/>(74 Z-0-0-2)</p> <p>AF. 11</p> |
| Cable Dielectric size   | Description   | Torque (Nm)  |                                      |             |           |                 |   |           |                 |     |           |                 |    |   |  |
| ... 3 ...   | 11/21_H4-50-3-1   | 4  |                                      |             |           |                 |   |           |                 |     |           |                 |    |   |  |
| ... 4 ...   | 11/21_H4-50-4-1   | 5.5  |                                      |             |           |                 |   |           |                 |     |           |                 |    |   |  |
| ... 5 ...   | 11/21_H4-50-5-1   | 10   |                                      |             |           |                 |   |           |                 |     |           |                 |    |   |  |

The cable assembly of R.F. connectors can only be done by well trained assembly stuff and suitable assembly equipment.  
Huber+Suhr's skilled stuff and specialised equipment are available to carry out complete R.F. lead-assembly on your behalf.  
We mount your connectors on cables at economic prices! Please contact our representative for further details of this service.

|           |          |
|-----------|----------|
| Revision  | C        |
| Date      | 08.09.06 |
| Initiator | 4779/JPE |

Deutscher Text: siehe Rückseite



|                         |   |                                    |            |
|-------------------------|---|------------------------------------|------------|
| <b>Verbinder-Typ:</b>   | 11/21_H4-50-3-1 ; 11/21_H4-50-4-1 ; 11/21_H4-50-5-1 | <b>Innenleiter Kontaktierung:</b>  | Gelötet    |
| <b>Geeignete Kabel:</b> | RG 58 C/U ; RG 59 B/U ; G 05232                     | <b>Aussenleiter Kontaktierung:</b> | Geschraubt |

## Stückliste Verbinder:

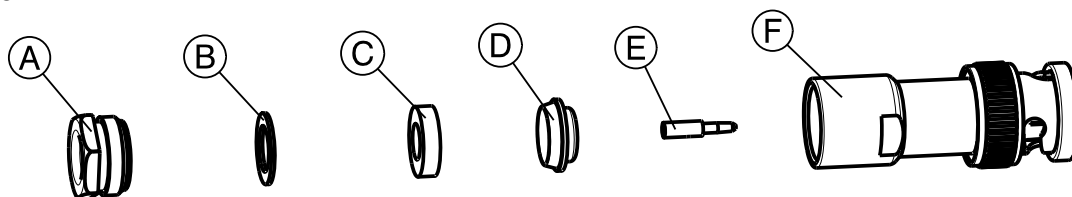

## Montage Schritte:

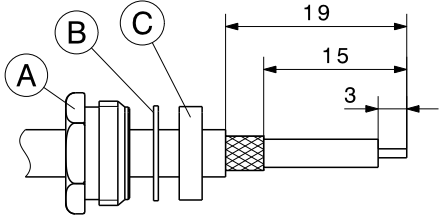
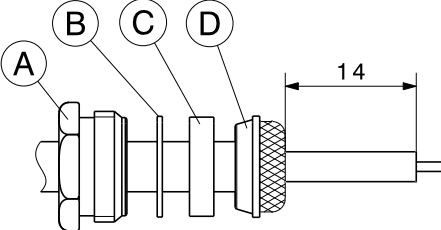
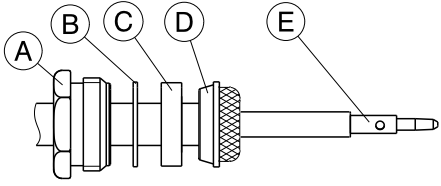
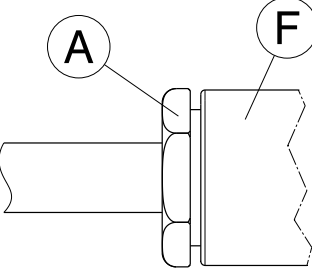
| Bild  | Prozess  | Merkmal / Prüfung  | Werkzeuge                        |                    |           |                 |   |           |                 |     |           |                 |    |   |  |
|---|--|--|----------------------------------|--------------------|-----------|-----------------|---|-----------|-----------------|-----|-----------|-----------------|----|---|--|
|    | <p>Nippel A, Scheibe B und Dichtung C auf das Kabel schieben.</p> <p>Kabel gemäss Figur abisolieren.</p>   | <p>Abschirmung, Dielektrikum und Kabelinnenleiter nicht beschädigen.</p> | <p>Stanley Messer<br/>Schere</p> |                    |           |                 |   |           |                 |     |           |                 |    |   |  |
|   | <p>Klemmring D sorgfältig über Abschirmung bis an den Mantel stossen.</p> <p>Abschirmung über Klemmring D zurückstülpen.</p>   | <p>Mass 14 mm kontrollieren.</p>   |                                  |                    |           |                 |   |           |                 |     |           |                 |    |   |  |
|  | <p>Kontakt E auf Kabelinnenleiter schieben und löten.</p>  | <p>Kontakt E bündig zum Dielektrikum.</p>                                | <p>LötKolben<br/>Lot</p>         |                    |           |                 |   |           |                 |     |           |                 |    |   |  |
|  | <p>Vorbereitetes Kabel in Gehäuse F einführen.</p> <p>Nippel A einschrauben und fest anziehen.</p> <table border="1"><thead><tr><th>Kabel – dielek – trikums-Ø</th><th>Verbinder</th><th>Dreh – moment (Nm)</th></tr></thead><tbody><tr><td>... 3 ...</td><td>11/21_H4-50-3-1</td><td>4</td></tr><tr><td>... 4 ...</td><td>11/21_H4-50-4-1</td><td>5.5</td></tr><tr><td>... 5 ...</td><td>11/21_H4-50-5-1</td><td>10</td></tr></tbody></table> | Kabel – dielek – trikums-Ø   | Verbinder                        | Dreh – moment (Nm) | ... 3 ... | 11/21_H4-50-3-1 | 4 | ... 4 ... | 11/21_H4-50-4-1 | 5.5 | ... 5 ... | 11/21_H4-50-5-1 | 10 | <p>Kabel gegenüber Gehäuse nicht verdrehen.</p> | <p>Gabelschlüssel : (74 Z-0-0-2)<br/>SW 11</p> |
| Kabel – dielek – trikums-Ø  | Verbinder  | Dreh – moment (Nm)   |                                  |                    |           |                 |   |           |                 |     |           |                 |    |   |  |
| ... 3 ...   | 11/21_H4-50-3-1  | 4  |                                  |                    |           |                 |   |           |                 |     |           |                 |    |   |  |
| ... 4 ...   | 11/21_H4-50-4-1  | 5.5  |                                  |                    |           |                 |   |           |                 |     |           |                 |    |   |  |
| ... 5 ...   | 11/21_H4-50-5-1  | 10   |                                  |                    |           |                 |   |           |                 |     |           |                 |    |   |  |

Die Montage von HF-Verbindern kann nur durch geschultes Personal, das über die richtige Ausrüstung verfügt, erfolgen. Huber+Suhr verfügt über ausgebildete Fachkräfte und rationelle Einrichtungen zur Herstellung kompletter HF-Verbindungsleitungen. Wir montieren Ihre Verbinder zu wirtschaftlichen Preisen! Wenden Sie sich an unsere Vertreter.

|          |          |
|----------|----------|
| Version  | C        |
| Datum    | 08.09.06 |
| Erstellt | 4779/JPE |