

## DC -21 GHz Low Pass Filter

## LPF-21GS1

RVA 1

### Specifications

1	Pass Band Frequency	DC ~ 21GHz
2	Pass Band Insertion Loss	≤1.0dB @ DC~20GHz ≤3.0dB @ 20~21GHz
3	Pass Band VSWR	≤1.6
4	Stop Band Rejection	≥50dB @ 22.2 ~ 27GHz
5	Impedance	50 Ohms
6	Power Handling	15W Max.
7	Connectors	SMA-Female
8	Surface Finish	Black Painted
9	Temperature Range	-55℃ ~ +85℃
10	Net weight	About 15g

### Dimensions (Unit: mm, Tolerance: ±0.3mm)

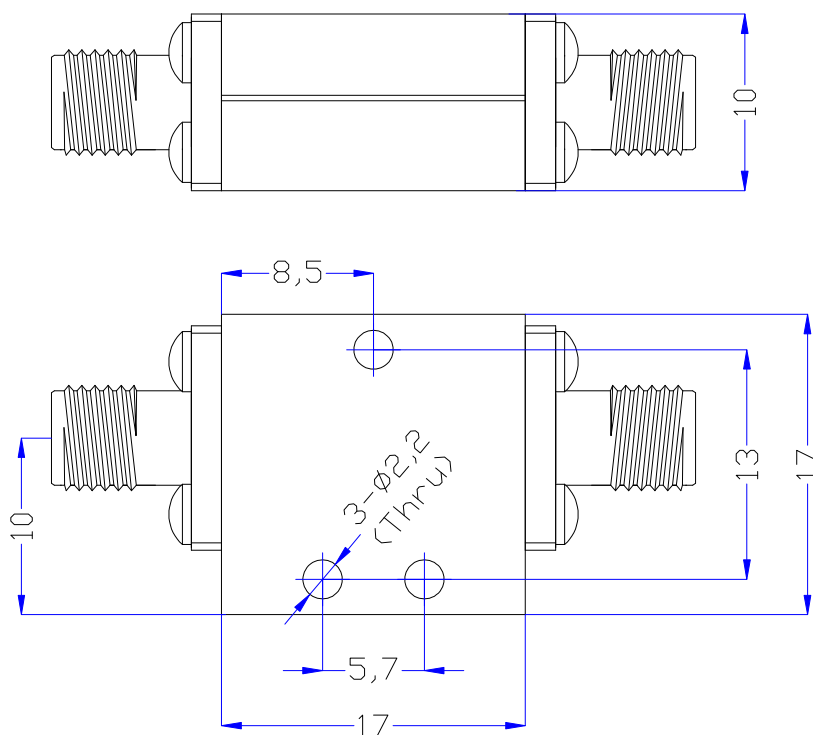

## Typical test data

