

## Unity Gain $\frac{1}{4}$ $\lambda$ Mobile Antenna for the 900 MHz Band

### DESCRIPTION

- Black-chromed whip with large bandwidth.
- Nice, discrete design.
- Type MU 901-X/l covers 820 – 905 MHz (e.g. for EAMPS).
- Type MU 901-X/h covers 870 – 960 MHz (e.g. for ETACS, NMT-900 and EGSM)
- Stainless steel X-mount with M6-thread whip-fastening system.
- Simple mounting exclusively with access from the outside.
- Models available with X-mount (oblong), CX-mount (circular) and MM-mount (magnetic).
- Choice between two connection principles:
  - X-mount, MM-mount: FME-connection (supplied without cable).
  - XP4-mount: Permanently attached 4 m low loss cable terminated with FME-connector.

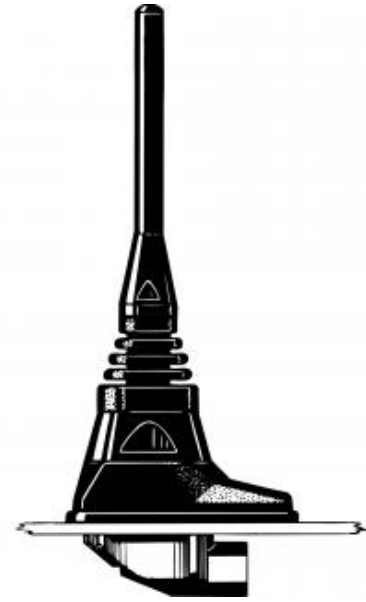

### SPECIFICATIONS

Electrical	
Model	MU 901-X...
Frequency	900 MHz-band covered by two models
Antenna Type	Mobile antenna
Max. Input Power	60 W
Polarisation	Vertical
Impedance	50 $\Omega$
VSWR	$\leq 1.2$ @ f. res.
Bandwidth	$\geq 90$ @ VSWR $\leq 1.5$ $\geq 180$ @ VSWR $\leq 2.0$
Gain (EIA RS-329-1)	0 dB
Mechanical	
Materials	Whip: Black-chromed brass Mount: Black-chromed brass Environment-proof plastics Stainless steel
Installation Torque	4 $\pm$ 1 Nm
Colour	Black
Height	Approx. 82 mm / 3.23 in.
Weight	X-version : Approx. 60 g / 0.13 lb. XP4-version : Approx. 200 g / 0.44 lb. MM-version : Approx. 270 g / 0.6 lb.
Mounting	18 mm dia. hole

### ORDERING

Model	Product No.	Description	Frequency
MU 901-X/l	130001149	X-mount (oblong) with FME-system	820 - 905 MHz
MU 901-X/h	130001142	Same mount as above	870 - 960 MHz
MU 901-CX/l	130001150	CX-mount (circular) with FME-system	820 - 905 MHz
MU 901-CX/h	130001143	Same mount as above	870 - 960 MHz
MU 901-XP4/l	130001151	XP4-mount (oblong) with 4 m cable + FME-system	820 - 905 MHz
MU 901-XP4/h	130001145	Same mount as above	870 - 960 MHz
MU 901-CXP4/l	130001152	CXP4-mount (circular) with 4 m cable + FME-system	820 - 905 MHz
MU 901-CXP4/h	130001146	Same mount as above	870 - 960 MHz
MU 901-MM/l	130001137	MM-mount (magnetic) with FME-system	820 - 905 MHz
MU 901-MM/h	130001138	Same mount as above	870 - 960 MHz

### ORDERING NOTE

To help selecting the correct model for a specific cellular network please consult the survey of cellular network frequencies under USEFUL DATA in our catalogues.

THE WHIP IS COMPATIBLE WITH ALL BELOW MOUNTS

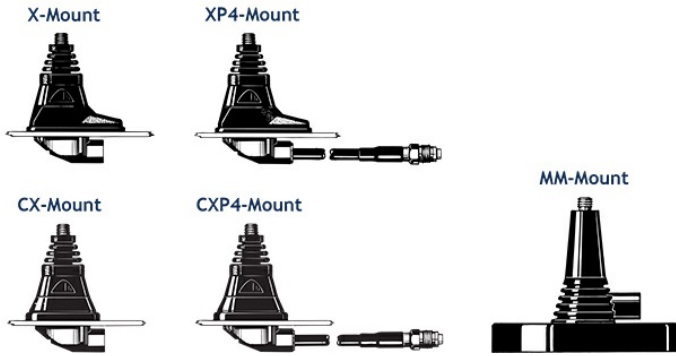

INSTALLATION

This antenna should be mounted on the car roof to ensure best omnidirectional coverage. Mounting can take place exclusively with access from the outside when drilling an 18 mm dia. hole. Mounting can take place from the inside by drilling a 14 mm dia. hole. When mounting in a 14 mm dia. hole, remove the bottom plastic ring of the packing gasket with a sharp cutter.

When cleaning the car in car-washing machines, remove the whip using a spanner, size 9 mm. After wash, refit the whip and tighten it lightly with the spanner.

The MiniMag (abbreviated: MM) is a small, light-weight magnetic mount with a high attaching effect. A silicone layer applied to the contact surface protects the car roof and ensures maximum friction.

1. INSTALLATION DIMENSION

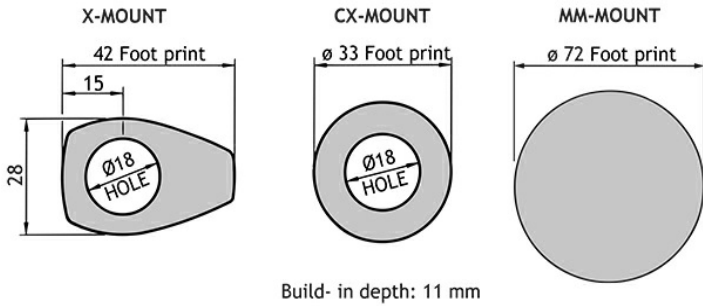

2. INSTALLATION STEPS

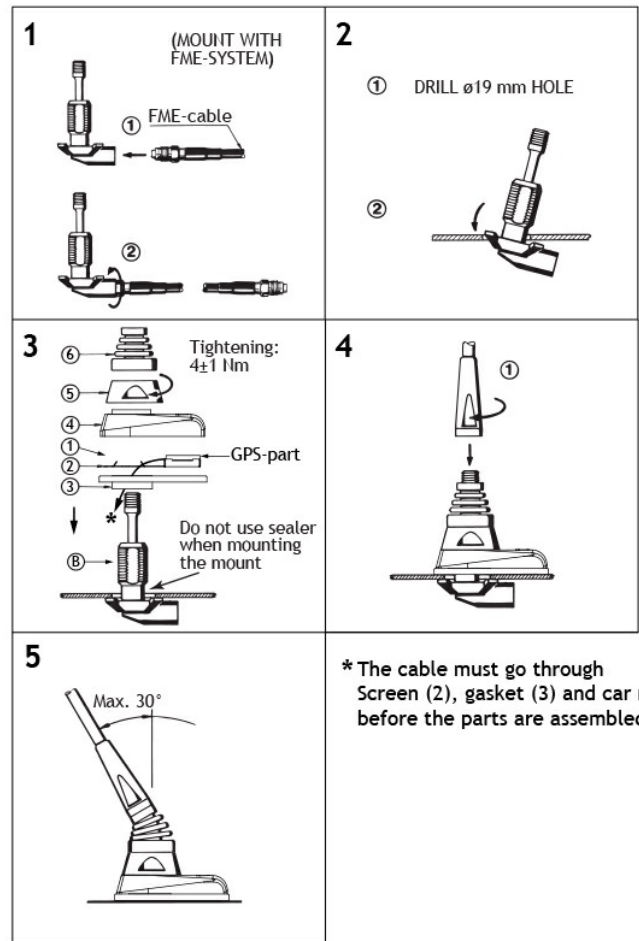

Do not use sealer on rubber gasket or other places.

3. TUNING

The antenna is delivered factory-tuned and requires no further tuning.

PLEASE NOTE

For safety reasons:

- When using the MU 901-MM/..., car speed must not exceed 140 km/h.
- If operating the MM-mount with other whips, whip length must never exceed 320 mm, and utilizing this maximum length, car speed must not exceed 115 km/h.