

Coaxial Fixed Attenuator

RFHB04XXBC2

DC-4 GHz, 1-60 dB, 2 Watts, BNC, Bidirectional



Rev 3

Electrical

Impedance	50 ohm			
Frequency Range	DC-4 GHz			
VSWR	1.2 max			
Input Avg Power	2W@ 25℃ ambient, derating linearly to 0.2W at 100℃			
Peak Power	250W (5 micro-sec pulse width, 0.4% duty cycle)			
Direction	Bidirectional, BNC female to BNC male (other configurations available)			
Attenuation(dB)	1-6	7-20	21-30	40-60
Accuracy(dB)	±0.3	±0.5	±0.75	±0.8

Mechanical

Connector Body	Ternary alloy plated brass
Heat Sink	N/A
Center Contact	Gold plated beryllium copper/brass
Net Weight	About 18 g

Environmental

Operating Temperature	-55℃ to 100℃
Storage Temperature	-55℃ to 125℃
RoHS	Compliant
Temperature Coefficient	<0.0004 dB/dB/℃

Dimensions(mm)

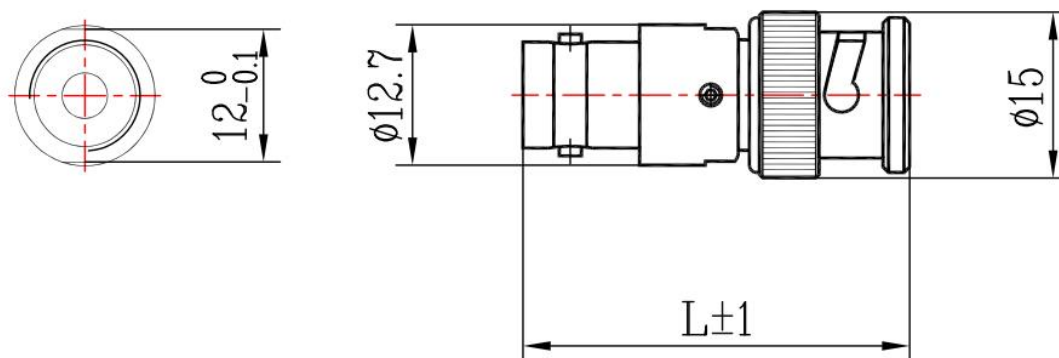

1-30dB: L=35
40-60dB: L=38

Notes

1.Customized dB values, outlines and optimal accuracy/VSWR available.

Model Description

RFHB04XXBC2

1.XX for dB value: 06=6dB,30=30dB

2.Code for connector configuration:

A=female for two ends; B=male for two ends

C=female for one end and male for the other.